

# BIPLANE CLASS OPTIMUM RACE PATH

CRITERIA: 275 MPH • 3.0 G's and 250' AGL

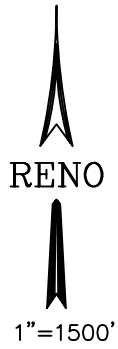

## LEGEND

- BIPLANE COURSE
- PYLON NUMBER — ●
- DEGREES OF TURN —  $4 | 46^\circ$
- GROUND ELEVATION — 5240'
- PYLON — ▲

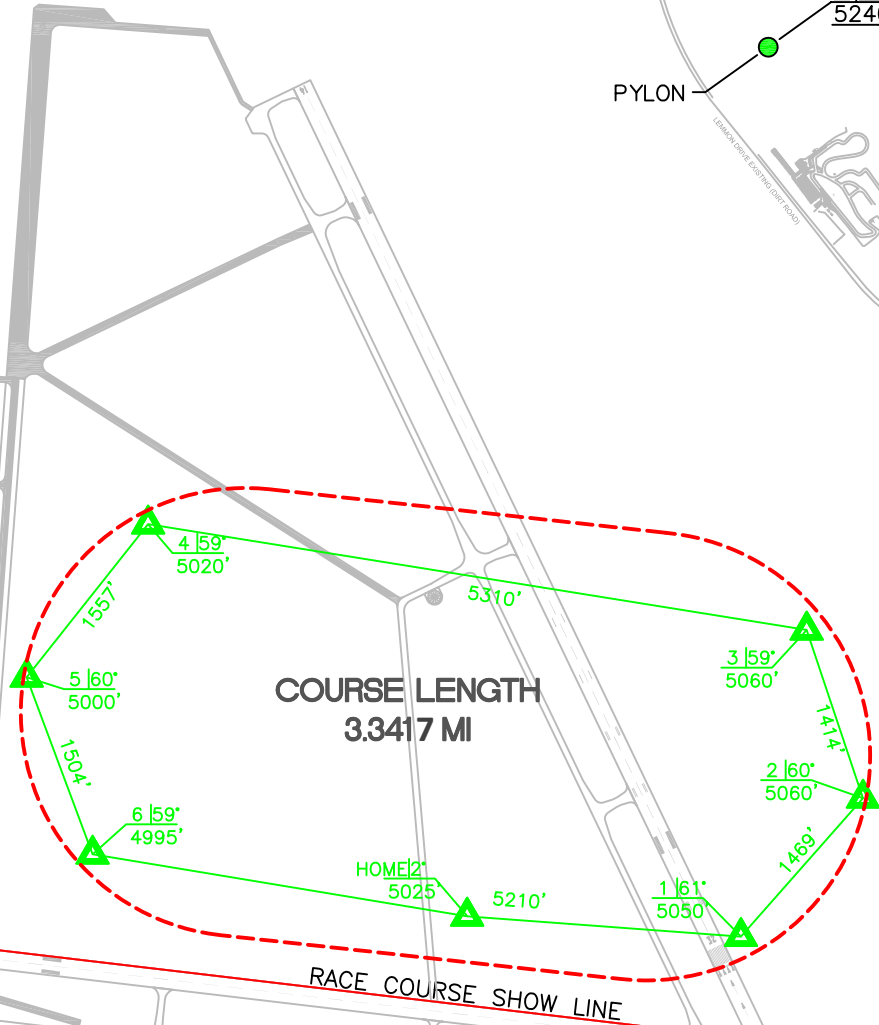

**APPROVED COURSE**

*Matthew Setty*

M.M. SETTY 5/10/2014

MAP BASED ON RENO/STEAD

ALP DATED 10/16/08 (REV. DATE: EL. 4915L APPROX.)

REV 5/18/2014

RARA COURSE MASTER.dwg mms

XREF: BIP\_275MPH\_3.0Gs.dwg mms

# 2014 OPTIMUM RACE PATH

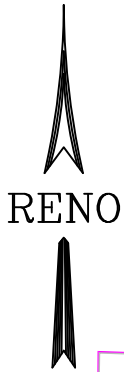

- - - - - **FORMULA ONE COURSE**  
3.1875 MILES
- - - - - **BIPLANE COURSE**  
3.3417 MILES
- - - - - **T-6 COURSE**  
4.9352 MILES

- - - - - **UNLIMITED COURSE**  
8.0851 MILES  
Start Lap = 7.5888 MILES

- - - - - **JET COURSE**  
8.1025 MILES  
Start Lap = 7.6113 MILES

- - - - - **SPORT GOLD COURSE**  
8.0782 MILES  
Start Lap = 7.5934 MILES

- - - - - **SPORT COURSE**  
6.9680 MILES  
Start Lap = 7.5660 MILES

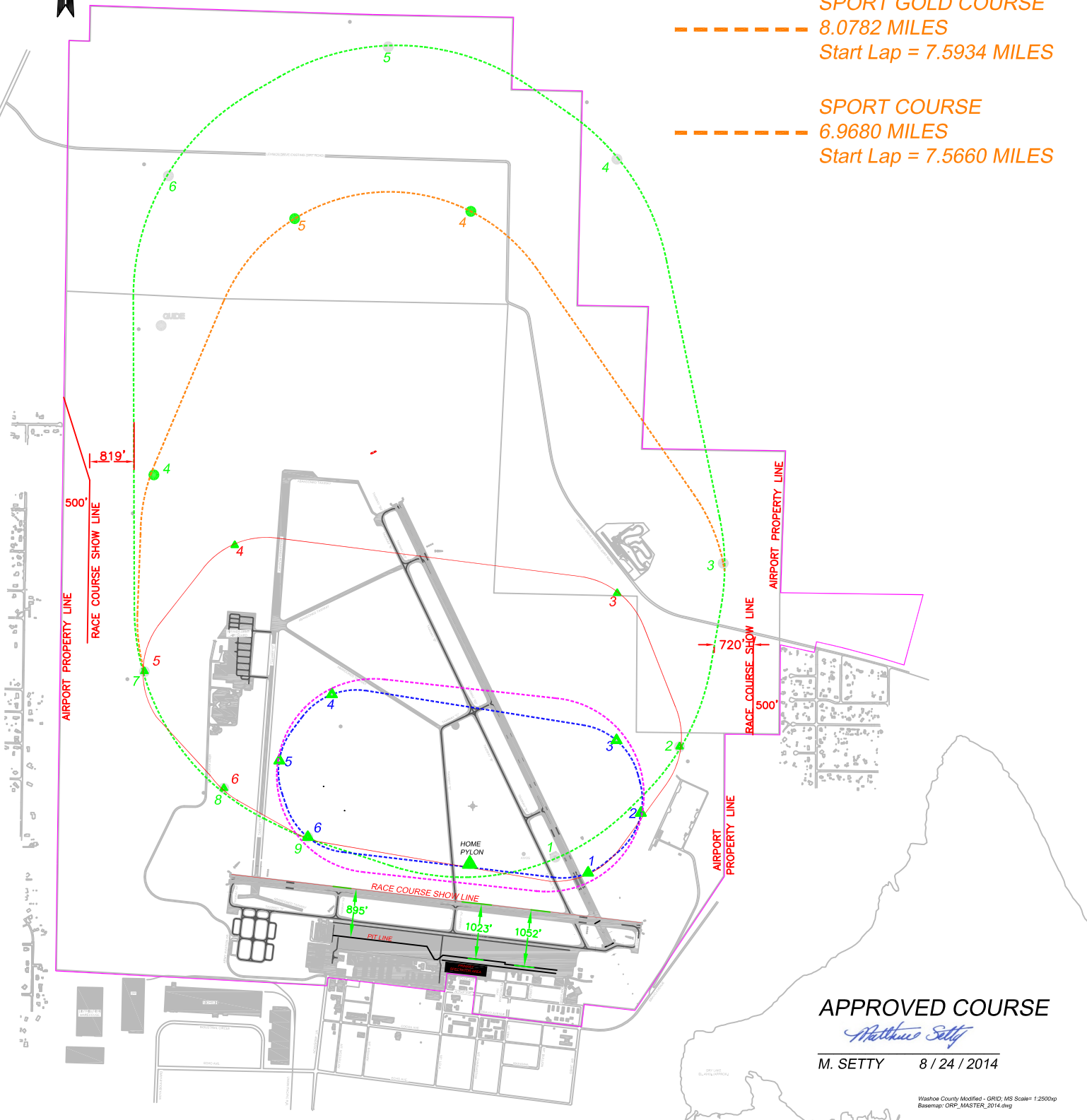

**APPROVED COURSE**

*Matthew Setty*

M. SETTY 8 / 24 / 2014